

HOW TO TILE SHOWERS

A STEP BY STEP GUIDE



WHAT YOU NEED.

Water damage can have expensive consequences. Avoid this with Dunlop's expertise. Because tiling in showers is constantly exposed to water, it is especially prone to problems, so it is wise to heed these general guidelines;



TILE CONSIDERATIONS

The tiles should be dry and the tile backs should be free from dust, wax and any other contamination which may affect the performance of the tile adhesive used.

Additionally, the weight of tiling should not exceed that which the background can support.

20kg/m² for plaster
32kg/m² for plasterboard
30kg/m² for plywood

WHAT TO USE

Preparation:
Dunlop Shower Waterproofing Kit

Adhesion:
Dunlop Waterproof Wall Tile Adhesive or Dunlop Set Fast Plus (depending on tile type / size)

Grouting:
Dunlop Anti-Mould Grout with Microban[®], or Dunlop Ready Mixed Grout with Microban[®] or Dunlop Flexible Wall Grout

Finishing:
Dunlop Silicone Sealant with Microban[®]

BEFORE YOU START

Ensure the background is in a sound condition.

Chipboard is not suitable for wet areas but marine plywood is suitable provided it is firmly screw-fixed.

CONSTANT SUPPORT

Full instructions for surface preparation and product usage appear on all Dunlop packaging. To make the job easy and worry-free, please ensure you follow them.

You can also view this tutorial online, or on WAP enabled phones. Just go to www.dunlop-adhesives.com or www.dunlop-adhesives.mobi from your mobile*.

*You will need a video compatible mobile device and media player to watch our video content. You must have your SIM card activated to receive data via GPRS and WAP. For more information, contact your mobile operator. Please note: If you have a lot of text messages, images or videos you may run out of memory, if this happens please delete some of your files to create more free space.

WHAT YOU NEED.

Water damage can have expensive consequences. Avoid this with Dunlop's expertise. Because tiling in showers is constantly exposed to water, it is especially prone to problems, so it is wise to heed these general guidelines;

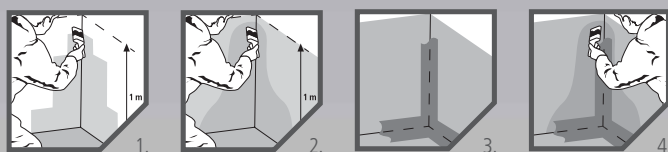

PREPARATION

For water sensitive backgrounds and in areas where movement might occur, the use of Dunlop Shower Waterproofing Kit is strongly recommended. Dunlop Shower Waterproofing Kit can be applied in the following easy steps:

1. Mark a line to the height of 1 metre on the wall parallel to the sides of the shower tray.
2. Prime the area previously marked out by brushing the Waterproofing Primer (from the Kit) in horizontal strokes and leave until touch dry. Repeat this process by brushing vertically making sure that all of the area has been fully primed.
3. Apply a layer of waterproof coating with a paintbrush to the three internal corners (where the 2 walls meet and along the top of the shower tray).
4. Cut the waterproofing tape to the required length and push into the wet layer of coating on the wall, ensuring no voids are left beneath the tape. Repeat this process applying the tape as a continuous strip to the wet layer of coating around the shower tray. Ensure the tape slightly overlaps the shower tray.
5. Apply a second layer of waterproof coating over the tape and remaining wall area up to the height of 1 metre. Depending upon temperature, allow a minimum of 24 hours before applying the tile adhesive.

ADHESION

In Power Shower areas use Dunlop Waterproof Wall Tile Adhesive for ceramic tiles less than 300 x 300 mm. For large format tiles (i.e. over 300 x 300 mm) or porcelain tiles then Dunlop Set Fast Plus must be used.

If tiling with Ceramic Tiles less than 300 x 300mm:

1. Dunlop Waterproof Wall Tile Adhesive is a ready mixed adhesive specially formulated for fixing ceramic or mosaic wall tiles in showers. It has excellent non-slip properties which reduces any need for battens.
2. Spread the adhesive over about 1m², or about 20 minutes working time.
3. Apply adhesive to a depth of 3mm, forming horizontal ribs. Use a special solid-bed notched trowel for wet areas.
4. Press the dry tiles into the adhesive with a twisting action to ensure that the tiles are fixed as far as possible in a solid bed of adhesive free from all gaps and voids in wet areas. Fix tiles within 20 minutes of spreading adhesive. If in doubt, check exposed adhesive ribs. If the adhesive is not sticky it must be removed and fresh adhesive applied.
5. Lift tiles occasionally to ensure adequate contact is made.
6. Immediately clean off surplus adhesive from the tile face with a damp cloth and remove excess adhesive from the grout lines.



GROUTING

7. Allow adhesive to fully dry out before grouting.

If tiling with Large Format tiles (i.e. over 300 x 300 mm) then use Dunlop Set Fast Plus.

1. If there is potential for background movement (eg. onto plasterboard, plywood and tile backerboard) or if you are tiling onto existing glazed tiles, always mix Dunlop Set Fast Plus with Dunlop Flexible Wall Grout Additive (diluted 1 part flexible additive with 1 part water).
2. Immediately after mixing, spread the adhesive paste onto the background using a suitable trowel. Large format tiles may require the back of the tile to be coated with a skim of adhesive.

Do not spread more adhesive than can be tiled within 10 minutes when using a rapid setting adhesive.

3. Press/push tiles firmly into position with a twisting/sliding action ensuring that good contact is maintained with the back of each tile. Ensure that the tiles are fixed as far as possible in a solid bed of adhesive free from all gaps or voids.
4. Clean off surplus adhesive from the tile face and from the tile joints.
5. Do not fix in temperatures below 5°C or damp conditions.
6. Allow the adhesive to fully dry out before grouting.

1. In normal drying conditions, grouting can be started after a minimum of 24 hours.

2. Suitable wall grouts can be used such as Dunlop Anti-Mould Grout with Microban[®], or Dunlop Ready Mixed Grout with Microban[®] or Dunlop Flexible Wall Grout.

3. If tiling onto surfaces that do not absorb water, grouting should be delayed for at least 3 days.

4. Work in small areas. Completely fill the tile joints with the grout using a grout-float or rubber squeegee and compact well. Remove any excess grout from the surface as work proceeds.

Allow about 10-15 minutes for the grout to dry sufficiently before cleaning off the tile surface with a dampened sponge.

5. Once the grout has hardened polish the tile surface with a clean dry cloth. Alternatively, give a final wash down with clean water and a dampened sponge.

FINISHING

Dunlop Silicone Sealant with Microban[®] must be used to provide a seal in corners and in junctions with other backgrounds, such as between the shower tray and wall.

Note: For general information on tiling in bathrooms, pick up our 'How to Tile Kitchens / Bathroom Walls' leaflet.

CHECKLIST



Make sure you have everything you need. Below is a quick checklist of the products and tools you will need to make the job simple and easy from start to finish.



CHECKLIST

- Tiles
- Tiles Trim

DUNLOP PRODUCTS

- Dunlop Shower Waterproofing Kit
- Dunlop Waterproof Wall Tile Adhesive or Dunlop Set Fast Plus (depending on tile type / size)
- Dunlop Anti-Mould Grout with Microban[®], or Dunlop Ready Mixed Grout with Microban[®] or Dunlop Flexible Wall Grout
- Dunlop Silicone Sealant with Microban[®]

TOOLS AND EQUIPMENT

- Wall Tile Spacers (2 or 3 mm)
- Tile Cutter
- Tile Nippers
- Tile Saw
- Tile File
- Suitable Notched Trowel
- Grout Squeegee/Float
- Sponge
- Sealant Gun
- Plastic Gloves

PLEASE CONTACT DUNLOP HELPLINE FOR FURTHER INFORMATION: 01782 591120

Microban[®] is a registered trademark of Microban Products Company